

# Artemide®

## ZEPHYR CHANDELIER

design  
Carlo Colombo

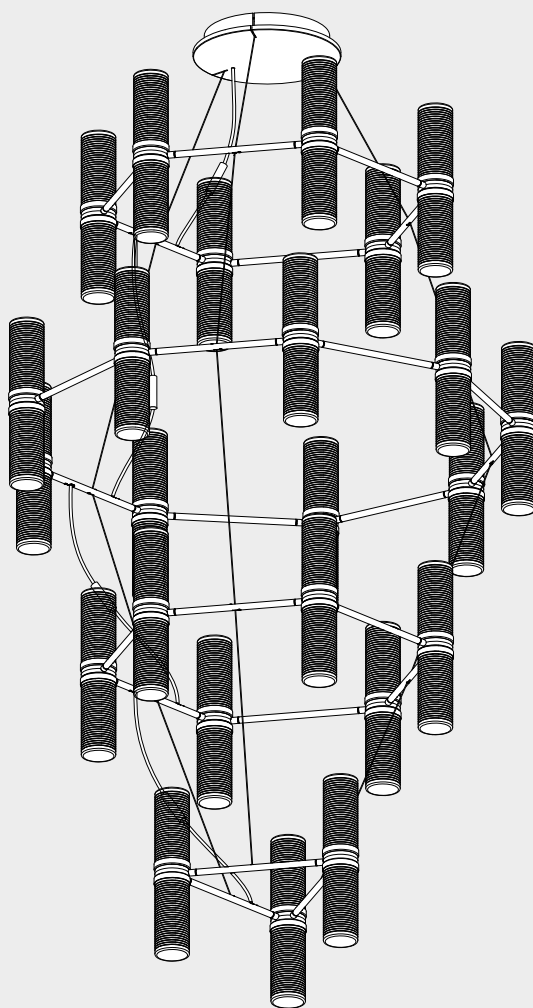



i



Artemide App  
Quick Starting Guide

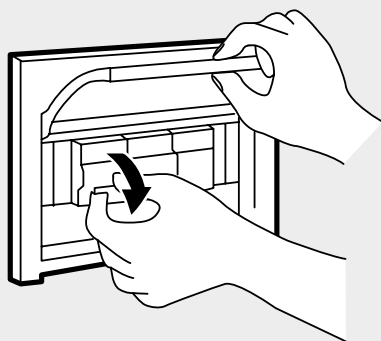
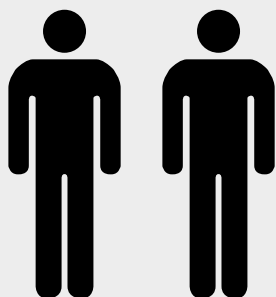

i

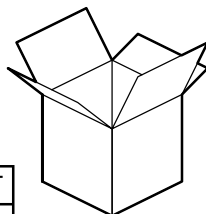
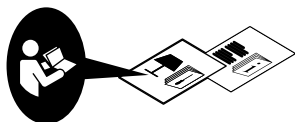
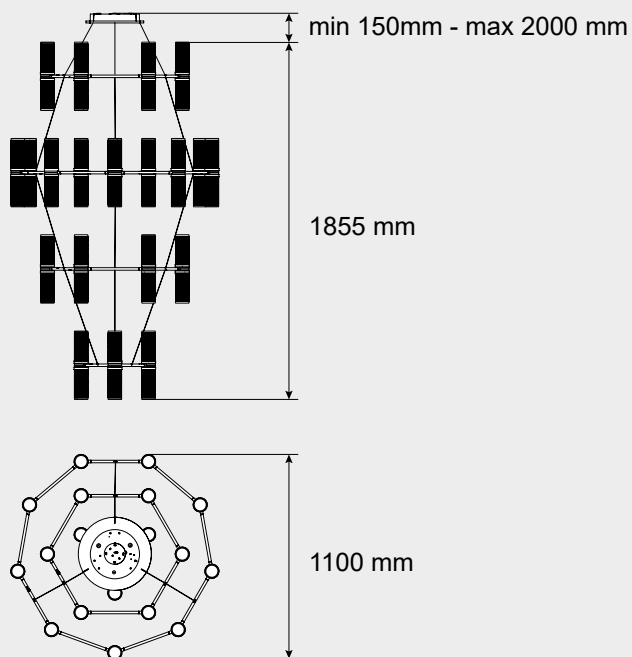

1784030A	DALI / PUSH POWER KIT
1784030APP	PUSH / APP POWER KIT

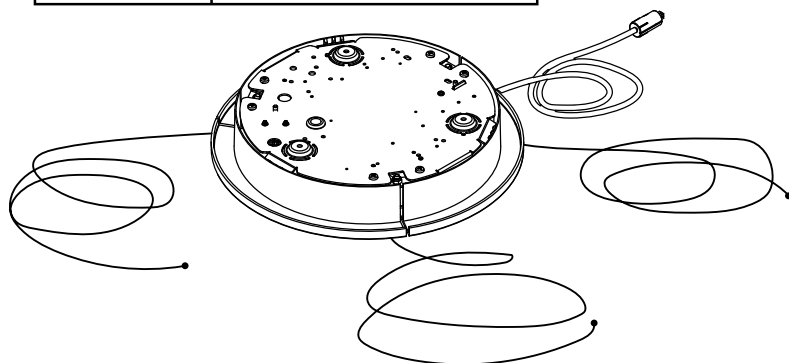



2x

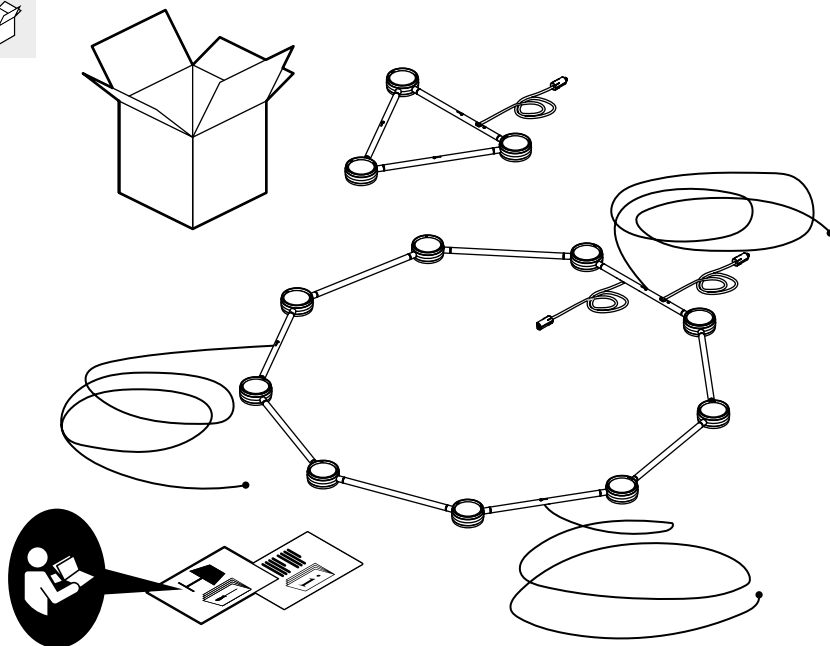
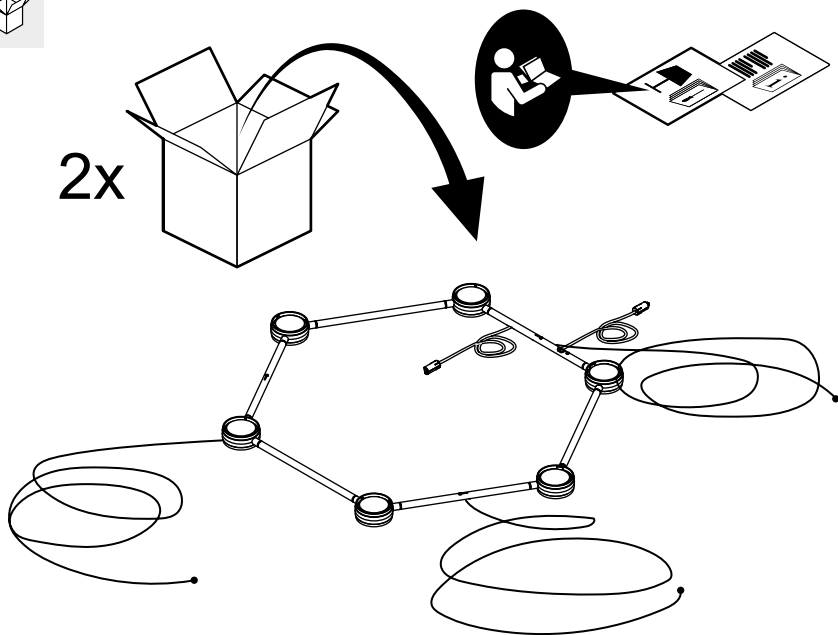

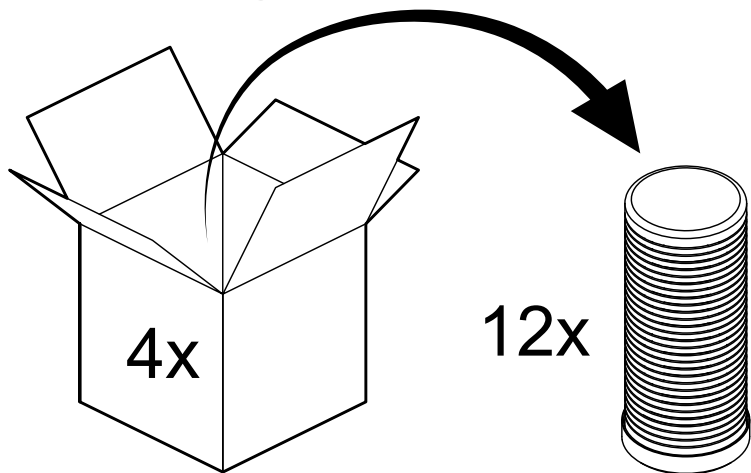
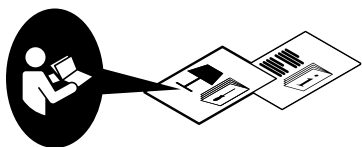

1

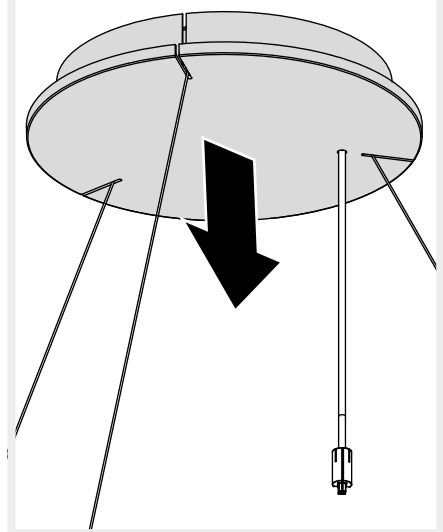

2

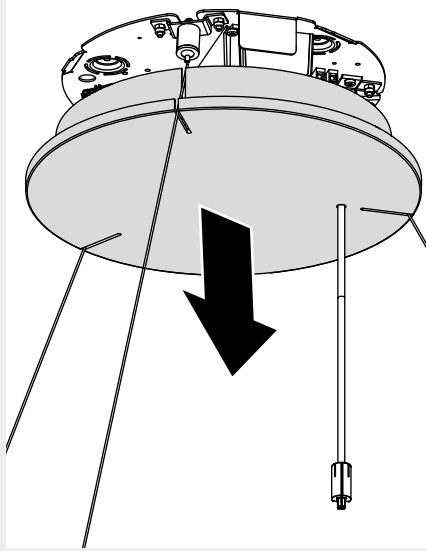

**i**

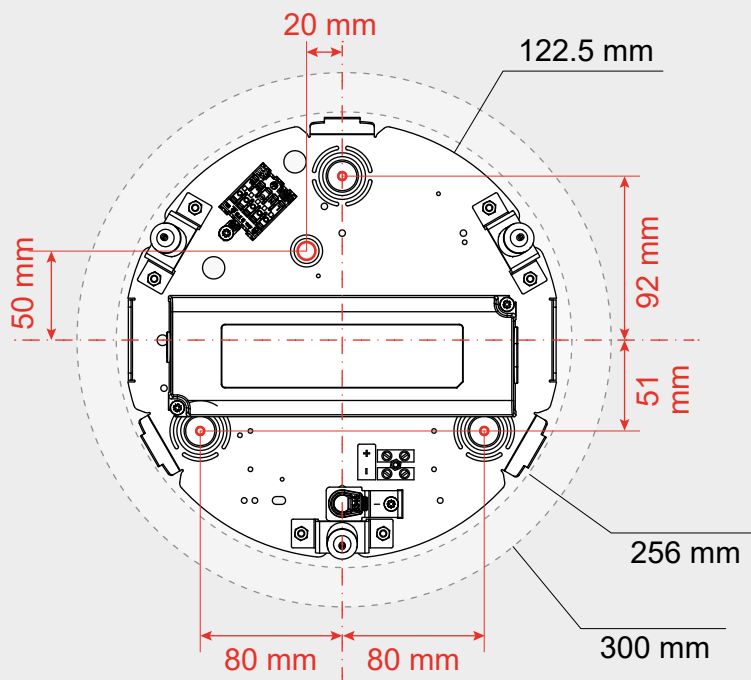

**3**

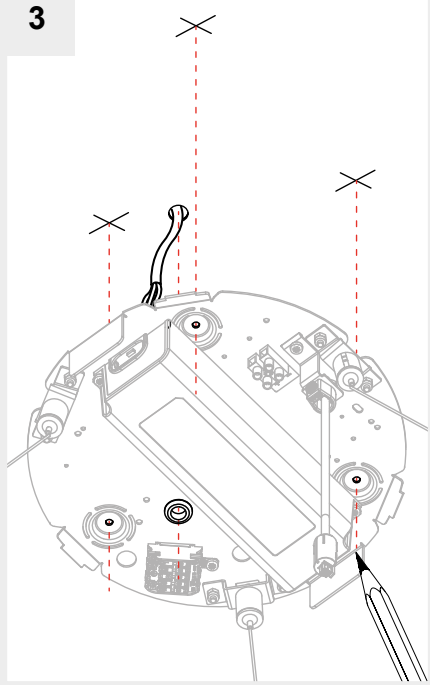

**4**

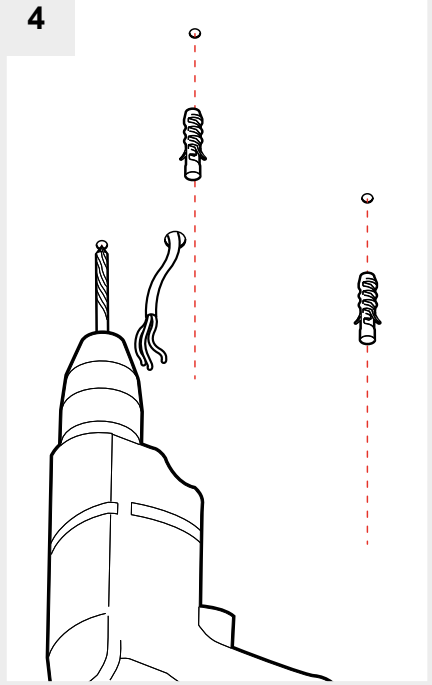

5

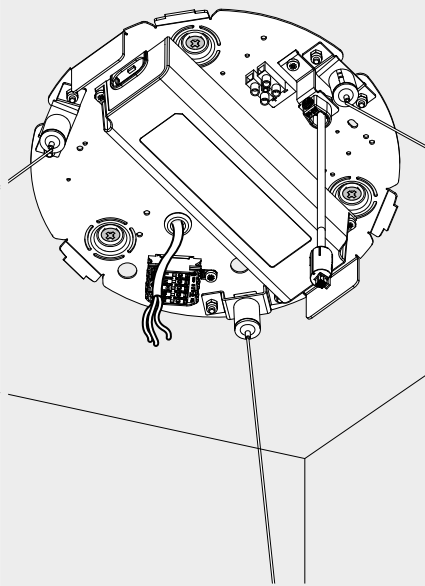
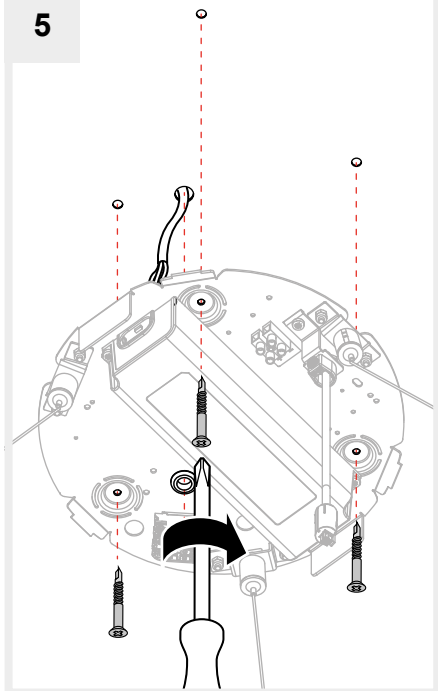

6a



1784030A

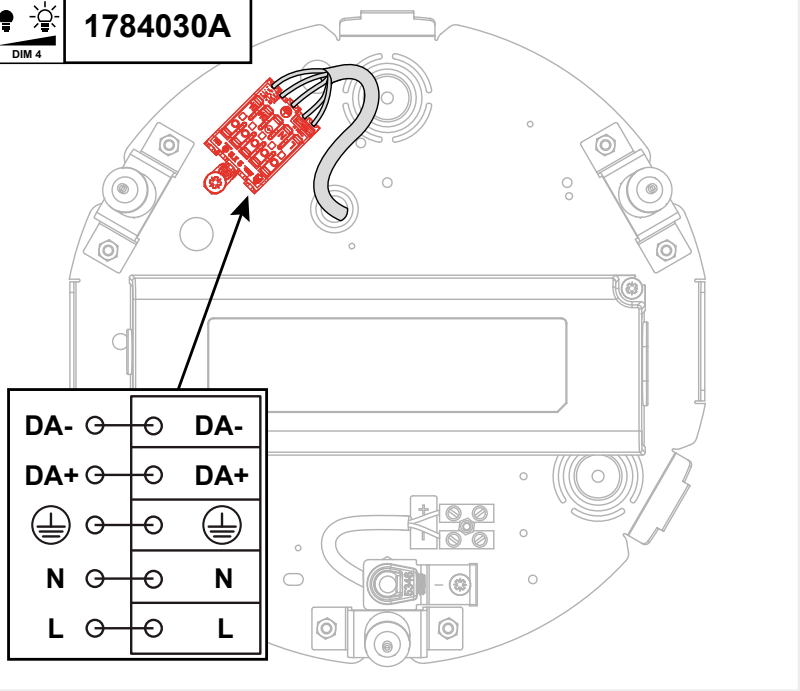

6b

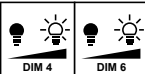

1784030A

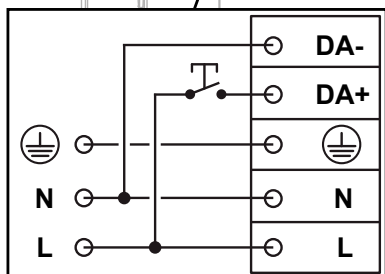

7a



1784030APP

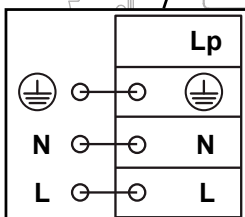
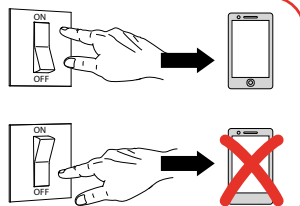



7b

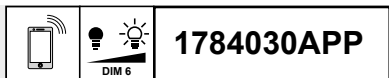

1784030APP

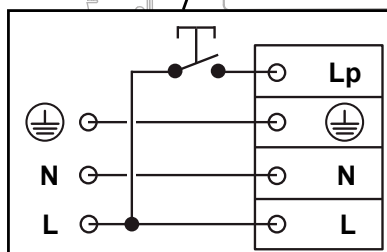
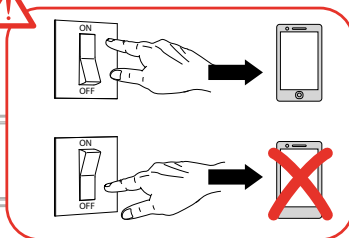

8

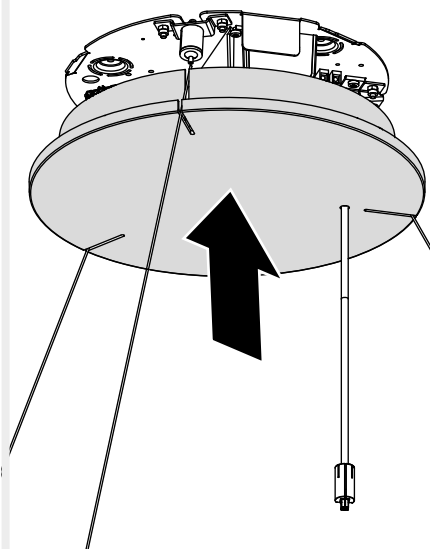

9

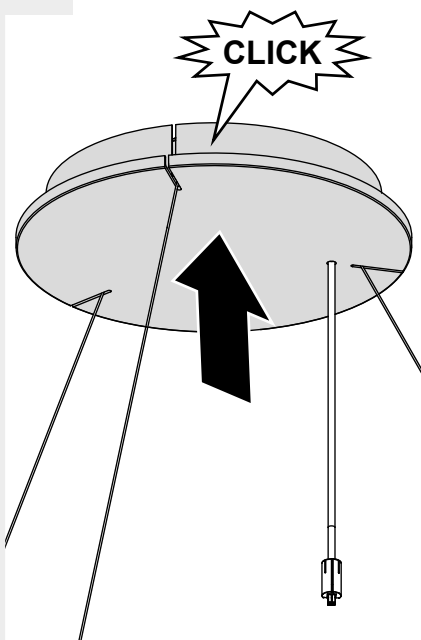

**i**

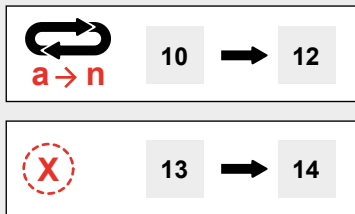
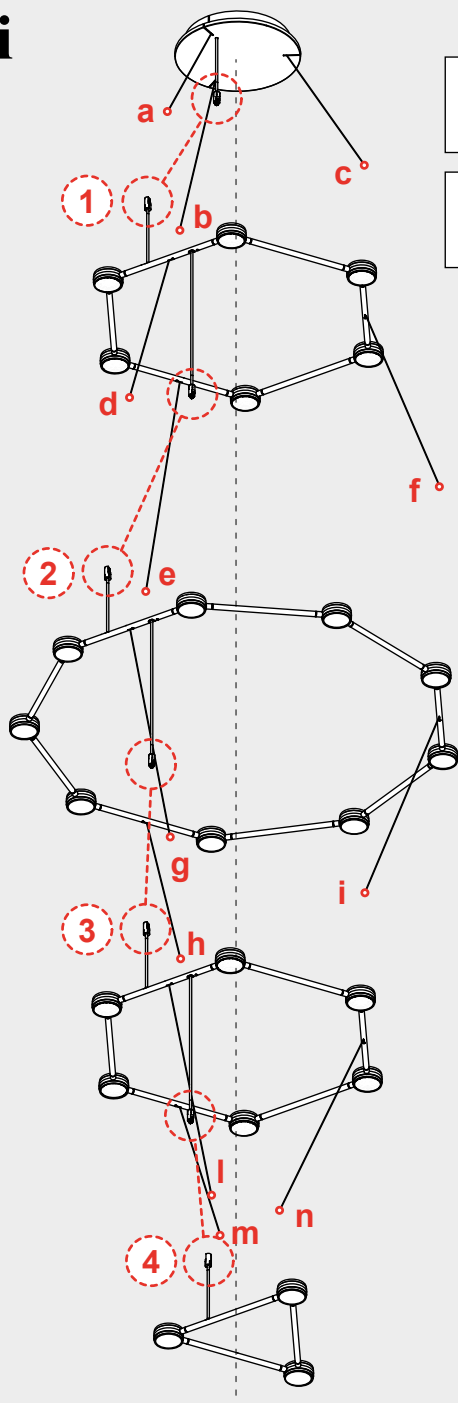

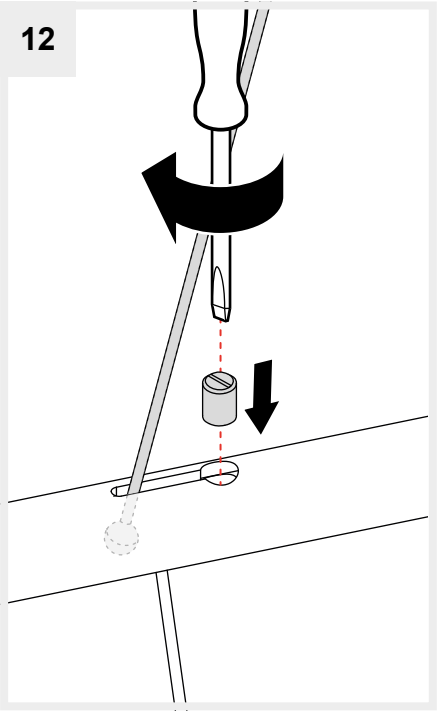
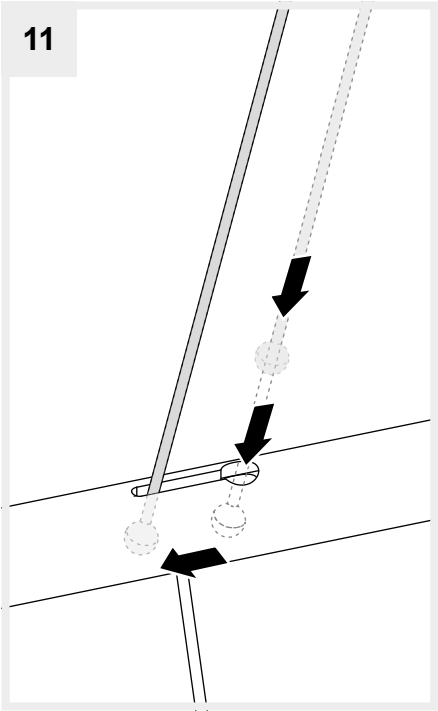
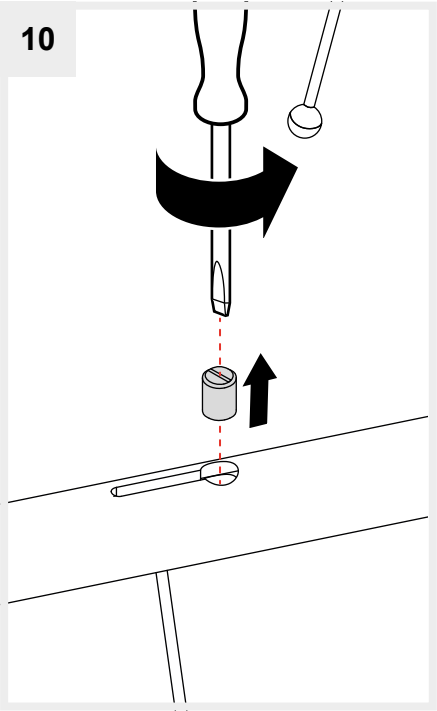
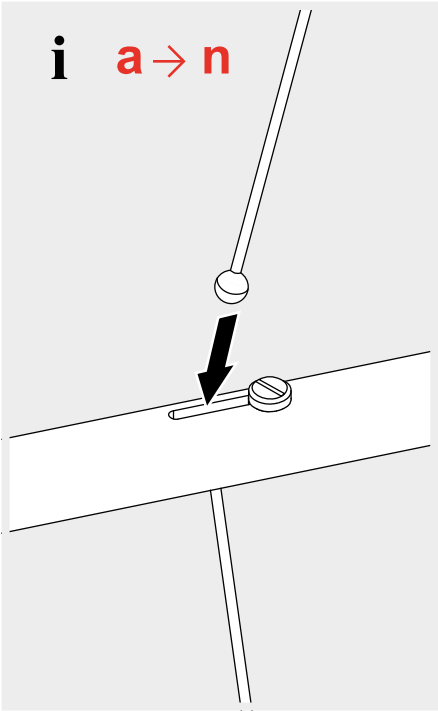

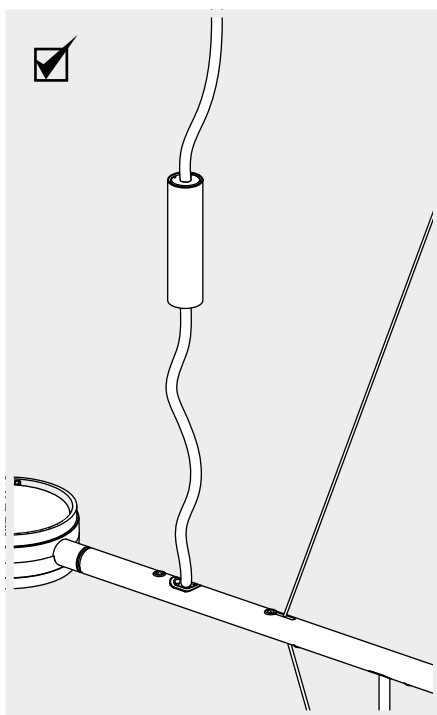
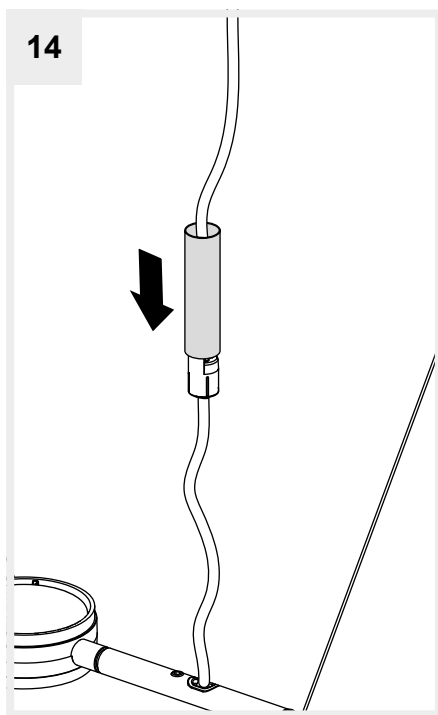
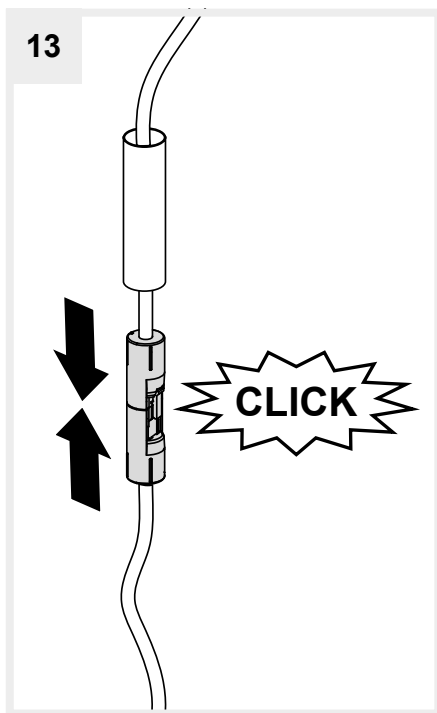
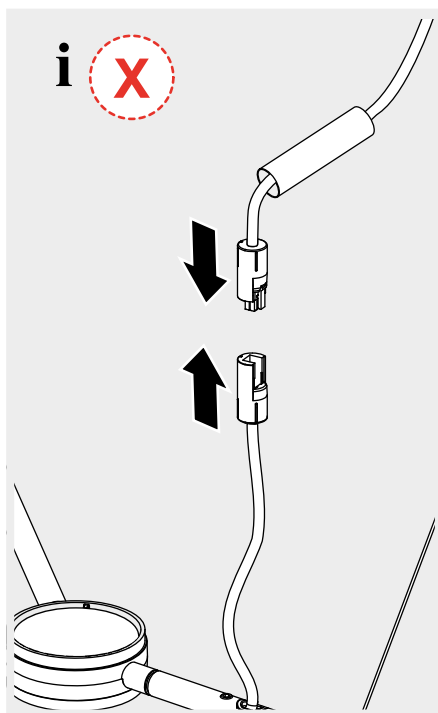

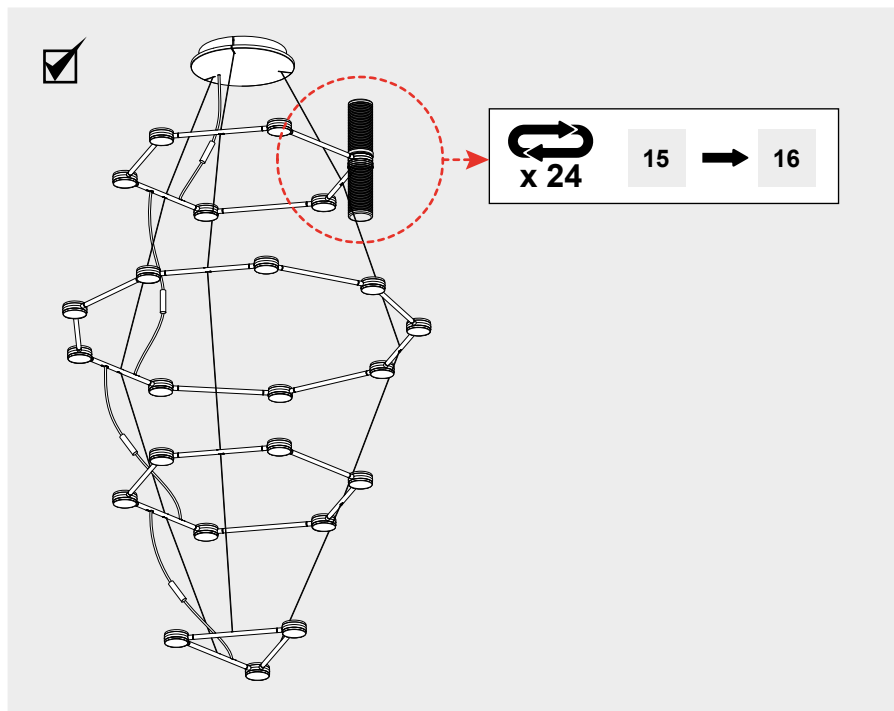
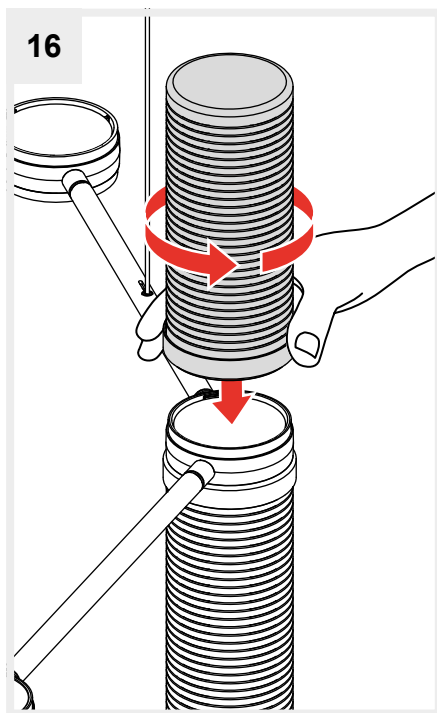
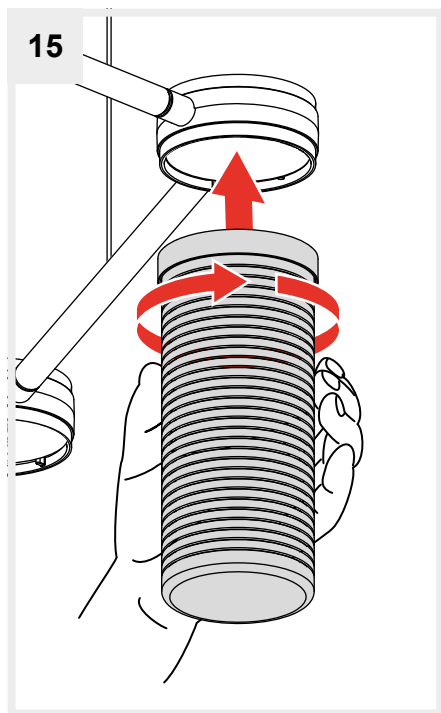

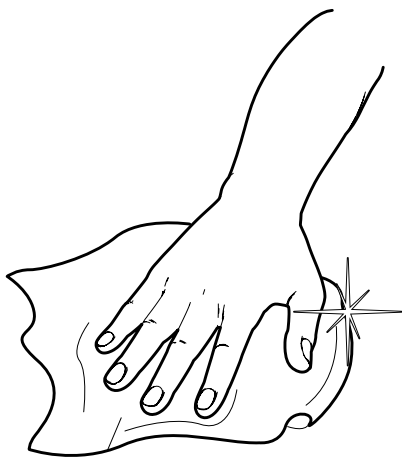
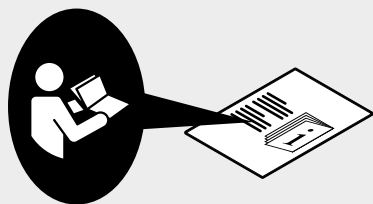
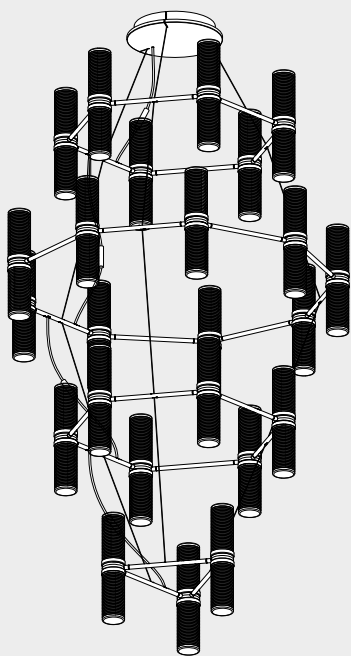



**Artemide®**

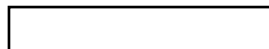

**Artemide**

via Bergamo, 18  
20006 Pregnana M.se (MI)  
ITALIA

tel. +39 02 935 181  
fax +39 02 935 90 254  
fax +39 02 935 90 496

[www.artemide.com](http://www.artemide.com)

VAT IT00846890150

cod. Y513002014D